

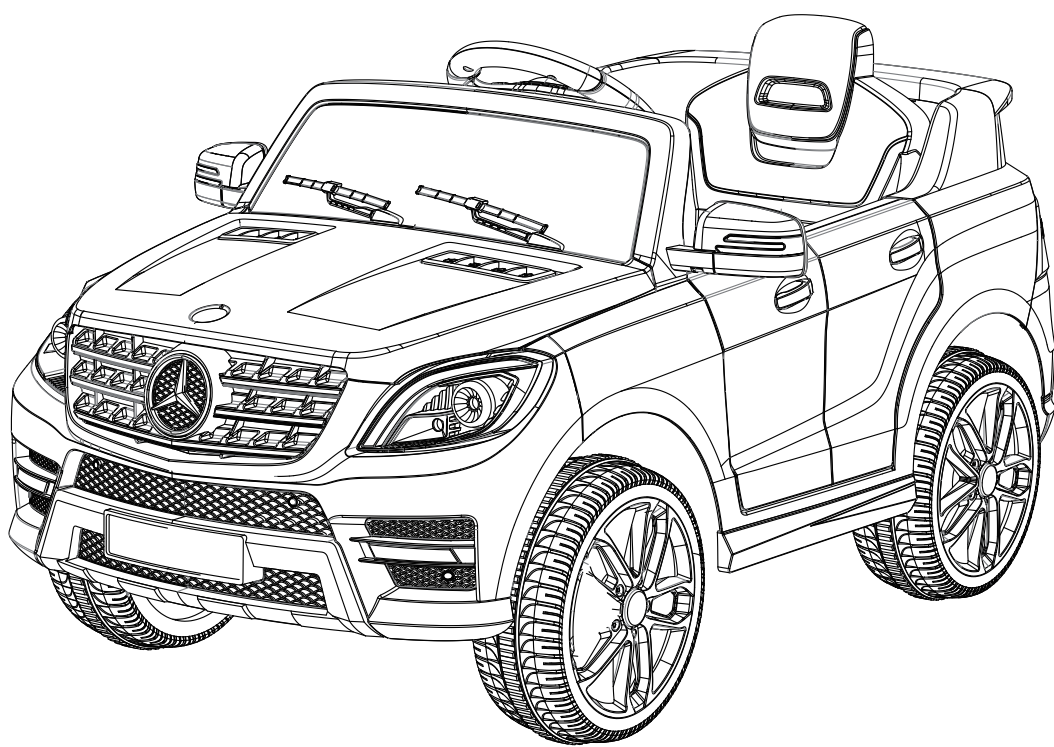

Mercedes-Benz

ML 350
Electric baby stroller
Assembly and Operation Instruction



“Mercedes-Benz” . and the design of the enclosed product are subject to intellectual property protection owned by Daimler AG.They are used by Jiaxing Adile Vehicle Industry Co.,Ltd.under license.

Instructions

Before using this product, please read the manual, it will tell you the correct method of operation and installation steps. In order to avoid improper operation and damage the product or hurt your baby. This manual should be kept in a safe place.

Profiles and specification

Name	Specification
Battery	12V4.5AH
Max weight	≤25kg
Speed	3-5km/h
Charger	Output: DC12V 500MA
Age	37-96months
Size	1120x570x400mm
Recharge times	8-12hours
Fuze:	Self-resetting fuse

Maintenance and maintenance

- After the regular service of the product, adults should regularly (suggest once two weeks) check the main items, including storage battery, charging device, wires, outer skin, circuit changer and switching valve. Clamp devices should be checked to see whether is loose. When there's hidden danger, the product should be stopped being used until restored.
- The vehicle should be cleaned by slightly wet (no water drop) soft cotton. Also can be polished by non-wax furniture in order to make the surface bright and clean. Do not use chemical dissolvent to wipe the plastic part of the toy to avoid being dissolved. The car cannot be cleaned by soap and water since water will damage the motor and storage battery, causing short pass of the electro-circuit system.
- After using for a period of time, please use lubricating oil to lubricate the iron part in order not to get rusty. The car should be kept away from high temperature and moistness, since the plastic parts might melt. When charging, please keep it away from inflammable materials so that fire will not occur.
- After using, please recharge it in time. Recharging should be operated by adults. If the car will not be used for a long time or be stored up, it has to be fully-recharged before storage. Then recharge it once every month to lengthen its life. When stop or not using for a long time, please cut off the power. All the circuit changers should be switched to "STOP" or "OFF". The structure and wire system cannot be altered without authorization. Maintenance and replacement of crucial parts should be supervised by professionals.
- In areas where power supply is unstable, installing power regulator is highly recommended to protect the storage battery when recharging. Do not use safety wires not accord with the product.

Component name

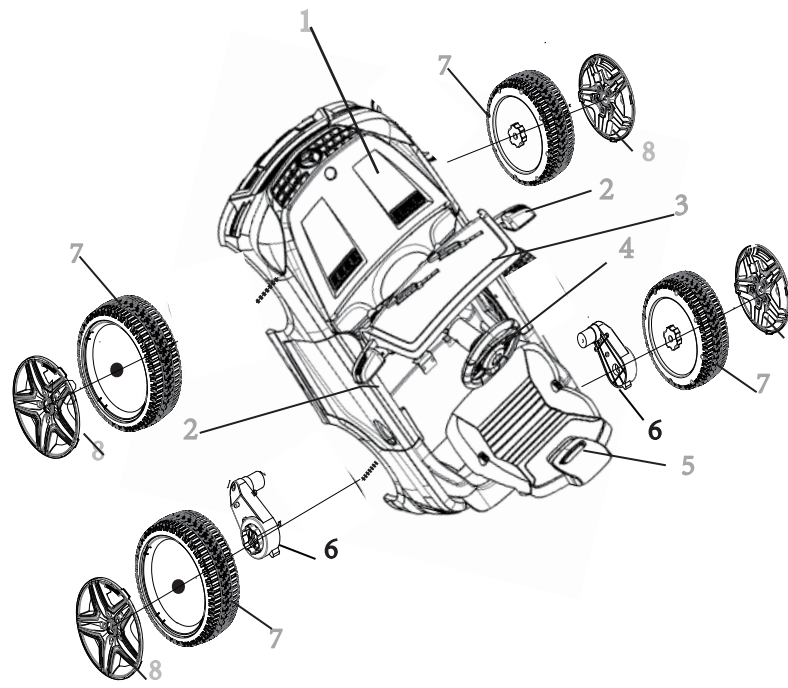

No.	Name	No.	Name	No.	Name
1	Car body	6	Gear box		
2	Rearview mirror	7	wheel		
3	Windshield	8	Wheel cover		
4	Steering wheel				
5	Seat				

Note: single drive gear box 1, double drive the 2 gear box (Gear Box Figure 6)

Assembling steps

- The assembling process before using has to be operated by adults. The whole process takes approximately 10 minutes.
- Minute parts has potential danger of choking. Children should be forbidden touching and playing.
- Tools needed in assembling: screwdriver (self-provided), vice (self-provided).
- Before assembling, please check the number of all the parts. The plastic package should be kept away from children since there's danger of choking.

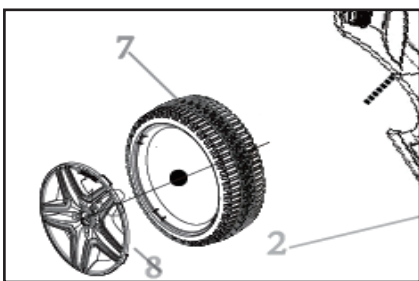

Installing front wheel:

- The middle of front wheel hole into the front axle.
- And then by hand in the middle of the wheel by the circular insert. (The side of the wheel with the boss facing in)
- Little harder by the middle of the wheel boss, and then the wheels under pressure, so that the wheel assembly in place. (Note: at the wheel pull the wheel assembly in place to confirm) Aim the buckle on the wheel cap at the neck on the wheel and push it down until you hear the click sound. It means the buckle has been installed in place.
- The other side of the assembly as above

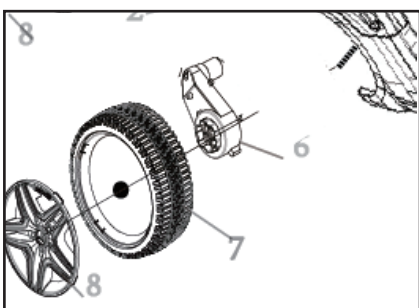

Installing rear wheel:

- L Left, R Right. And then the gear box into the rear axle, the other end and the wiring port into the body connection hole.
- Next put into the wheels, the wheels need to convex with the convex gear alignment, and then by hand into the middle by the quick-push.
- Little harder by the middle of the wheel boss, and then the wheels under pressure, so that the wheel assembly in place. (Note: at the wheel pull the wheel assembly in place to confirm) Aim the buckle on the wheel cap at the neck on the wheel and push it down until you hear the click sound. It means the buckle has been installed in place.
- The other side of the assembly as above

Note: single drive only one gearbox.

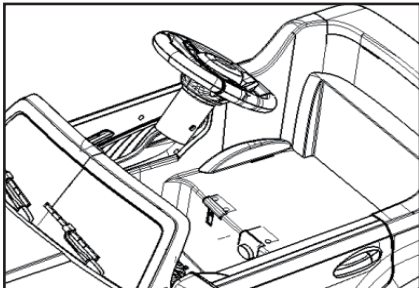

Installing steering wheel:

- First, the steering wheel base of the screw nut unloaded, and then set into the steering shaft (instrument panel in the middle of the prominent iron). Adjust the angle so that the base screw holes are aligned with the steering shaft screw holes. Finally, into the screw nut, with a screwdriver to tighten it.

Assembling steps

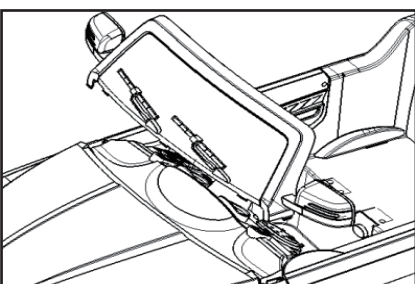

Installing windshield:

- The windshield issued by the bayonet and body card slot alignment, forced down, hear the "click" sound that the installation is complete.

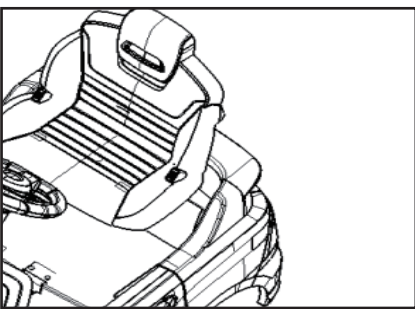

Installing seat:

- Align the chute of the seat base to the body position chute (see picture), and push it to the end
- Note: the seat can be adjusted before and after the 2 block. The button is located under the seat.

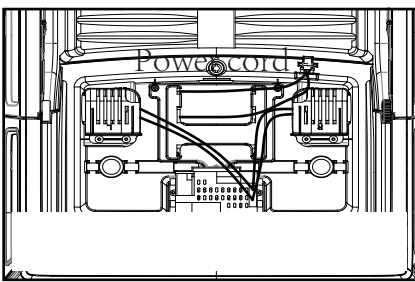

Connect the power:

- Connect the gearbox motor cable to the receiver board connector in the battery compartment.
- Connect the red battery cable to the red terminal of the battery and the black battery cable to the black terminal of the battery.

How to use it (please make sure the switch is on)

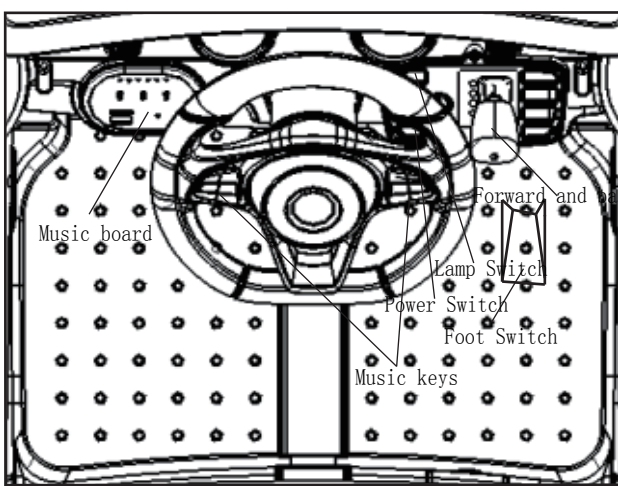

Warning!

When change the gear, please make sure the car is completely stopped. Or it will damage the gear case and motor

Forward:

- Press the "Forward/backward" switch to forward
- Slightly step on "foot switch", the car will moving forward

Stop

Lifting the foot to loosen the "foot switch", the car will stop

Backward:

- Press Switch the "forward/backward switch" to "backward"
- Slightly step on the "foot switch" the car will moving backward.

Remote control:

In this mode there's no remote control/manual switch

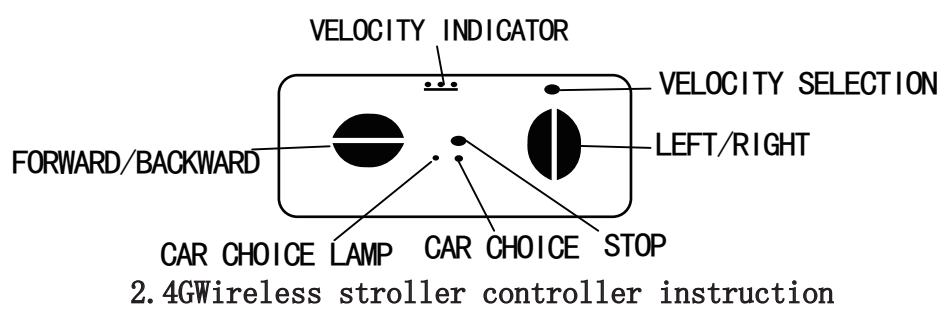

2. 4G wireless stroller controller instruction

How to use it

First, the first use (or replace the battery) need to code, the following steps:
Step 1: Install two AAA 1.5V batteries, push down the battery cover on the back of the remote control to open the battery cover, install the battery (note the positive and negative polarity inside the battery chamber), and close the battery cover;
Step 2: the first time on the code, you must turn off the stroller total power;
Step 3: Press and hold the code key, the communication indicator flashes, open the power supply, 3 seconds after the code is successful;
Step 4: After successful release of the code button, then the remote control is only after the car;
Step 5: If the frequency is not successful (not on the lights off), turn off the power supply stroller, repeat step two and three;

Second, the normal use

- Speed selection: 1 light is low, 2 lights are medium speed, 3 lights are high speed, each block speed with stepless variable speed start;
- Forward and backward keys have slow stop, press left and right keys to turn around, press the emergency stop button in any case emergency stop;
- Remote control or manually press the emergency stop button, the vehicle can stop moving;
- When the remote control does not use 15 seconds after the automatic cut off power, re-use without re-frequency;

How to use it

Battery warning

- The remote control car operation when adults and children riding a stroller distance of not more than 15M range.
- The remote control is only intended for use by the guardian, and must not be touched by the child.
- In the remote control operation, it is necessary to carefully read the instructions, and empty test, familiar with the master, before allowing children to ride.
- The remote control has energy-saving settings, when a period of time (10 seconds) when not in use, automatic power failure, all lights off, then press the key will re-work; frequency key in the initial use and replacement of batteries need to re-operate once;
- The remote control car shall not be in the motor vehicle road and water, obstacles and other places driving
- The remote control must not be allowed to rain or otherwise flooded to avoid damage to the circuit.
- Non-rechargeable batteries can not be charged.
- Rechargeable batteries can only be charged under adult supervision.
- The rechargeable battery should be removed from the toy before charging it.
- Different types of batteries or old and new batteries can not be mixed.
- The battery should be placed in the correct polarity.
- The exhausted battery should be removed from the toy.
- The power supply terminals must not be short-circuited.
- Long time without toys, toys should be removed from the battery, properly handled to prevent children from playing. If the remote control range of less than 3 meters, indicating that the remote battery is low, to replace the 7th alkaline (1.5V) two batteries.

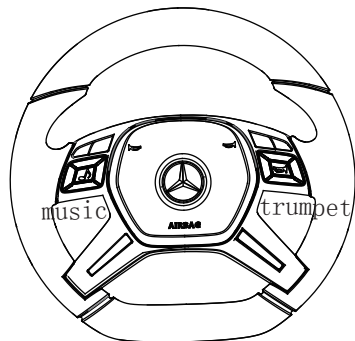
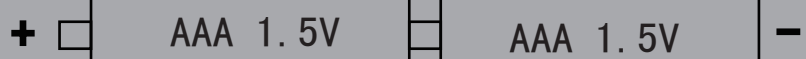

Music : Push the button on the steering wheel, there will be trumpet or music.

Charging

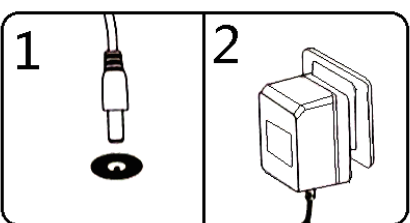
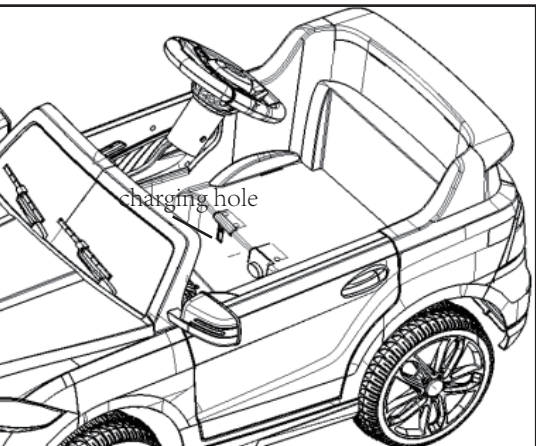

- Power switch must be turned in off when charging
- Charging seat is located in the rear right.
- Plug the charger into a local mains power wall outlet
- Plug in the charging seat on the electricity power

Matters need attention when charging

- The charging process has to be operated by adults.
- Before the firsts use of the car, make sure the battery has been charged more than 4-6 hours. Or the battery would be damaged permanently and cannot be repaired.
- When charging, please turn off the battery. Put the charger plug into the charging hole before plug it on the socket. The car cannot be operated when charging.
- When the battery is low, please charge it in time. Normally the charging hour is 8-12 hours, but do not charge it more than 20 hours.
- It is normal that the battery jar emits heat, but when the temperature is too high, you should examine whether the recharging process is over-current or short-current.
- When there is water in socket aperture, the battery jar cannot be charged since it will cause short-current.
- Only chargers and battery equipped by this car can be used. Chargers and battery jars of other brand are strictly prohibited. Or the charger and battery might be damaged.
- When the product is packed away or will not be used for a long time, you have to fully charge the battery and charge it once every month to guarantee the life of the battery.
- The charger and the battery are not toy. Children should not be allowed to play with them.

Charging

Using the method of auxiliary wheel, handle and matters needing attention:

- When the car is insufficient, turn off the power.
- The front bumper on the pulling out, after the bumper on the auxiliary wheel spins.
- Then hold the handle, the car will be brought into 45 degrees, drag the car.
- No children ride in the car using the handle auxiliary wheel.
- This operation must be adult operation.

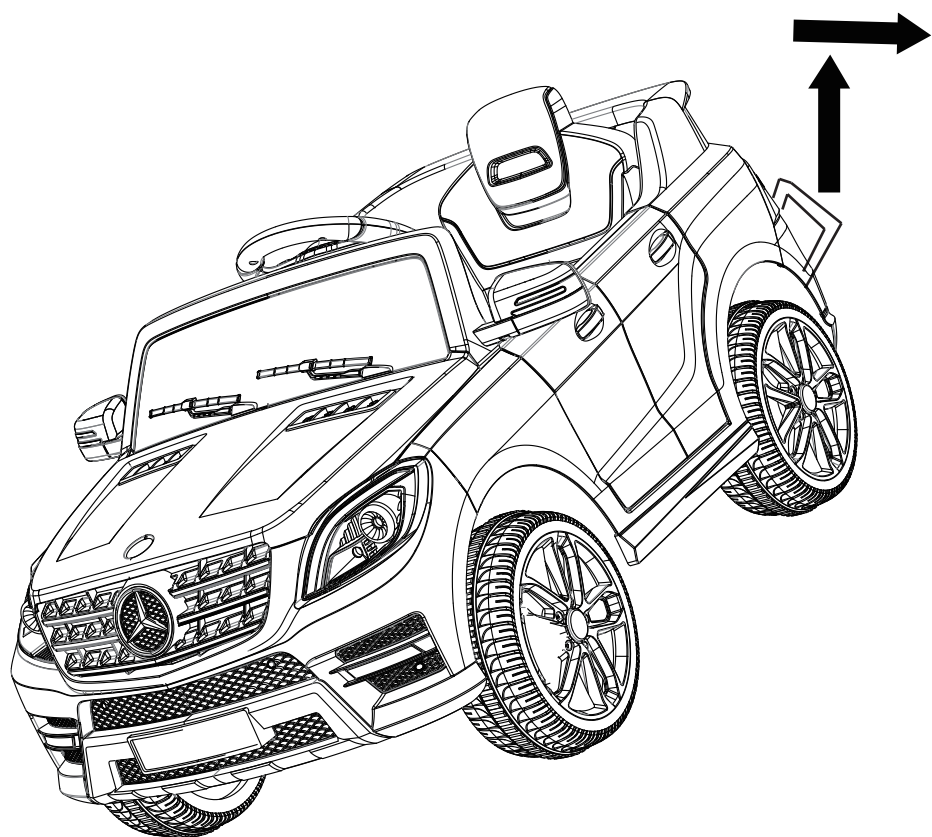

Simple maintenance

Fault type	Reason analysis	Exclusion methods
Car's not moving	1. Battery has low voltage 2. Fuse protection 3. The nut of the wheel is dropped off 4. Socked connector of the battery has fallen off 5. Battery is flat 6. Electrical damage 7. Motor is broken	1. Recharging the battery 2. Stop for several minutes before using again 3. Screw the nut on 4. Link it up again 5. Change a new battery 6. Go to the maintenance area 7. Go to the maintenance area
Battery cannot be recharged	1. Socket connector of the battery has fallen off 2. There's no power	1. Link it up again 2. Plug it in
Short flight mileage	1. Battery off 2. Battery is old	1. Recharging the battery 2. Change a new battery
There's slight sound and heat when recharging	1. This belongs to normal chemical reaction	1. It's normal
Low speed	1. Battery is old 2. Dead battery 3. Overload 4. Pavement irregularity	1. Change a new battery 2. Recharging the battery 3. Reduce weight bearing to below 30kg 4. Ride on smooth-riding surface
Gearbox has noise	1. Gear is broken	1. Repair it in maintenance point
Car is shaking when progressing	1. Connector cable for lens motor contact poorly 2. There's a dead spot on the motor	1. Reconnect it 2. Repair it in maintenance point

The above troubleshooting methods, the user does not have the conditions, please contact the maintenance department of the company after-sales service.

Warning

- The assembling and charging process could only be operated by adults.
- Before use, please check whether all the part are installed well to position and connected tightly
- When playing this car, the distance between the car and an adult cannot be more than 10 meters
- This car should only be rode under adult's supervision
- This car cannot be used on dangerous places like streets, roads, slopes and raceways. When there is barrier, please change directions to avoid it.
- Do not use it on smooth surfaces like marbles, floor tiles and glasses.
- Do not use this car on rainy or snowy days.
- Do not switch the forward/backward switch when advancing. Make sure kids are not standing on the seat.
- Do not change the structure, line and additional electrical devices without permission.
- The car is outfit with seat belt. Make sure the Child has fastened it.
- When the car is not used, please switch off the electric power source. When not used for a long time, pluck off the attaching plug.
- Examine the product and charger regularly to see whether the parts are becoming old or dropped off. When damage is found, the product should be stopped using until fixed.

PlayActive
outdoor toys for kids

Thank you for choosing a PlayActive product.
We hope your child will endure many years of fun with this item. If you require any trouble shooting assistance or help on assembly please view our tutorial videos available on our website.

www.playactive.net

WARNING!

Do not use this vehicle indoors. Using this vehicle in confined areas may cause the vehicle's motors to over load.

If you require any further assistance please contact the outlet you purchased this item from.