

KIDS QUAD RIDE ON ATV MANUAL

- Forward
- Backward
- Turn right
- Turn left
- Stop
- Light



• Product Size: 116*64*80CM

WARNING :Not to be used in traffic.

This product is designed for children age 3+.
Original License Counterfeit Investigated

The company has passed the ISO 9001:2008 quality management system certification



Parts name	A	B	C	D	E	F	G	H	I	J	K	L	M	N	O
Qty	1	1	1	1	1	2	1	4	8	5	4	2	1	2	

I. WHEELS INSTALLATION

Please check the different of the wheels (according to the follow photo)

Rear wheel Front wheel

Assembly Instructions:
Take off the nuts from the axle.
Take turn to fix the gasket (need not put the gasket to inside of the rear wheels), wheels, gasket, nut (fixed by the spanner), small wheels cover.



II. Steering lever and dashboard installation

Assembly Instructions:
Fixed the steering lever into the dashboard.
Align them with the ATV slot, please do not fixed.
Make the connect wire into the ATV slot, too.
Take out the connect wire from the circular part (according to the photo)



III. Connect wire installation

Take out all of the connect wire, connect the same color connection.

IV. Battery connect

Assembly Instructions:
Take off the plastic of insulation, red connection to red terminal.

WHILE CONNECTING TO THE STORAGE BATTERY TAKE CARE THAT THEY ARE CORRECTLY CONNECTED TO ENSURE THE RIGHT POLARITY

black connect black terminal
red terminal red connect

V. Dashboard installation

Check and confirm the function of lights
Push the dashboard until full into place. (according to the photo)

VI. Steering level installation

Fixed the steering level. Use the gasket and nuts by spanner.

VII. Hood installation

Align the hood with the ATV slot and push until full into place.

VIII. Front support frame installation

Align the front support frame with the ATV slot and push until full into place.

IX. Rearview Mirror installation

Align the rearview mirror with the ATV slot and push until full into place. (according to the photo)

Remark : Left and right rearview mirror is different.

X. Flagstaff installation

Align the flagstaff with the ATV slot and push until full into place. (according to the photo)



■ CHARGING PRECAUTIONS

Battery polarity can not be reversed, please ensure the red wire is connected to the red battery terminal and the black wire is connected to the black battery terminal.

Press the power switch to OFF position to turn the power off.

Open the seat, connect the battery plug, red to red.

Never drain battery completely or to a crawling speed, recharge the battery when a decrease in speed and power is noticed warranty will be voided if misuse has occurred.

Battery charging must be done by adults only. Never allow children to charge the battery. A child could be injured by the electricity involved in charging the battery.

Please don't connect the wires to a short circuit.

The charger and the battery are not a toy. Do not allow children to play with the charger and the battery.

Only operate the battery and charger specified according to the manual instructions.

Please don't open the battery and the charger.

Always secure the battery with the bracket. Or battery can be fall out and injure children if vehicle tips over.

The battery must be handled and operated by adults only.

The battery is heavy and contains sulfuric acid (electrolyte).

Dropping the battery could result in serious injury.

Before charging the battery check if wear or damage to the battery, charger, the connectors and other parts. Any damage is found, the charger should be repaired or replaced immediately. Do not use a damaged charger.

It is normal for the adaptor to feel warm during charging, but if the charger feels too hot, stop charging right now and check the battery and adaptor.

■ WHEN CHARGING TURN OFF THE POWER SWITCH

Please charge the battery for 8-10 hours after first use.

Subsequent charges should be 6-8 hours but not exceeding 10 hours.

If not being used batteries should still be charged at least once a month to keep the cells active.

1. Open the cover of charging socket on the car.

2. Plug the charge into the charging socket.

3. Plug the other end of the charger into your wall socket.

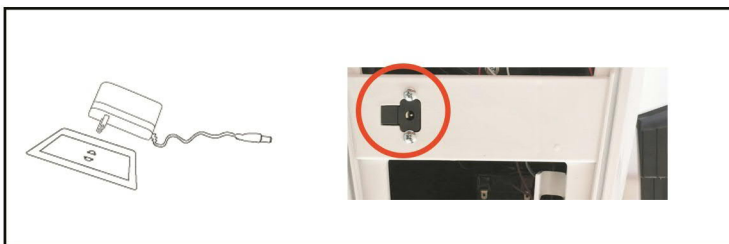

■ TROUBLESHOOTING

Problem: The car will not move

Answer 1: Please make sure the charger has been removed from the car charging point.

Answer 2: The battery is low on charge. Please charge for 6-8 hours but not exceeding 10 hours.

Charge at least once a month to keep the cells active.

To avoid fuse cut off the power:

1. Max: 30kgs, overload is forbidden
2. Do not drag any item behind this product.
3. Do not allow water or other liquids dip the electrical parts.
4. Do not change the line system by yourself.

Answer 3: The battery wires are not connected. Please check the connections on the battery terminals are firmly in place.

Answer 4: battery is broken

Please contact the agent or manufacturer

Answer 5: car body wiring has been damaged

Please contact the agent or manufacturer

Answer 6: the motor is damaged

Please contact the agent or manufacturer

Problem: unable to charge

Answer 1: The battery wires not connected. Please check the connections on the battery terminals are firmly in place.

Answer 2: The charger is not inserted in place

Make sure the charger is plugged into the power outlet properly {ensure the power outlet switch turn on}

Answer 3: The charger not working correctly. The charger should feel slightly warm when on charge. Please contact the agent or manufacturer.

■ TROUBLESHOOTING

Problem: The car only runs for a short time

Answer 1: The battery is low on charge. Please charge for 6-8 hours but not exceeding 10 hours

Charge at least once a month to keep the active.

Answer 2: Battery ageing

The battery may need to be replaced depending on its charging history and age.

Problem: Charger makes a buzzing sound while charging

This is normal.

Problem: Charger overheating

It is normal for the battery and charger to warm slightly during charging. If they feel excessively hot then please check for a current overload or battery short circuit.

■ FUNCTION INSTRUCTION

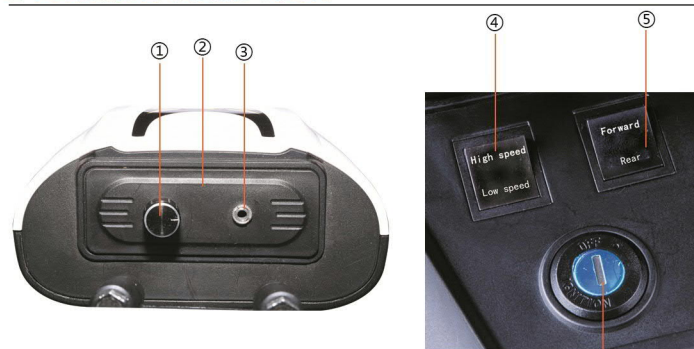

- 1) Volume adjust
- 2) Dashboard
- 3) MP3 interface
- 4) Low/High speed
- 5) Forward/Backward switch
- 6) Key start as real car, insert the key and turn it on.
- 7) Accelerator pedal



PlayActive

outdoor toys for kids

Thank you for choosing a PlayActive product. We hope your child will endure many years of fun with this item. If you require any trouble shooting assistance or help on assembly please view our tutorial videos available on our website.

www.playactive.net

⚠ WARNING!

Do not use this vehicle indoors. Using this vehicle in confined areas may cause the vehicle's motors to over load.

If you require any further assistance please contact the outlet you purchased this item from.

■ WARNING

WARNING: Vehicle must be charged fully before use.

Failure to do so voids warranty.

Warning: Not to be used in traffic

Please read manual carefully before use.

Adult assembly required.

This toy have no brake

Always wear a helmet and protective clothing when riding.

Continuous adult supervision required when using this product.

Charging the battery can only be done by adult at all times.

Please keep the manual and packaging for future reference as it contains important information.

The instructions for use should bear a reminder that the toy should be used with caution since skill is required to avoid falls or collisions causing injury to the user or third parties.

■ SAFETY PRECAUTIONS

01. While riding, adult supervision is required all the time.

02. Always wear a helmet when driving.

03. Please don't drive near road or on the footpath.

04. It is not recommended to drive the vehicle on wet surface or on slope greater than 15-degree.

05. It is recommended to drive this vehicle on smooth surface only.

06. Please don't driving this vehicle outdoors when it is raining.

07. Make sure that the vehicle stop completely before changing direction from forward to reverse.

08. Please don't allow children to operate the charger or play with the battery

09. Clean the vehicle with a dry cloth only.

10. Please follow the correct weight and age limits allowed to drive this vehicle.

11. It is prohibited to change the circuit or add other electric parts.

12. Adults must teach their children about safe driving procedures.

13. Please turn the power off when not in use.

14. Check the seat to ensure it has been fitted and secured with a bolt before driving.

15. Inspect all wires and connections of the vehicle periodically.

16. Charging the battery should only be done by adults.

17. Charging plug is located underneath the seat.

18. In order to avoid accidents, please ensure the vehicle is safe before driving.

19. Please don't let any child touch the wheels or be near them when the car is moving.

20. Warranty period is 90 days from the date of purchase.

21. Proof of purchase must be given for goods to be returned, repaired or replaced.

■ DISPOSAL OF BATTERY

Disposal of Battery



Your sealed lead-acid battery must be recycled or disposed of in an environmentally sound manner.

Do not dispose of your lead-acid battery in a fire. The battery may explode or leak.

Do not dispose of lead-acid battery in your regular household trash.

The incineration land filling or mixing of sealed lead-acid batteries with household trash is prohibited by law.

Return an exhausted battery to your local approved lead-acid battery recycle, Such as a local seller of automotive batteries.

Contact your local waste management officials for other information.

regarding the environmentally sound recycling and disposal of lead-acid batteries.